



M SERIES OVEN INSTALLATION GUIDE

GUÍA DE INSTALACIÓN

GUIDE D'INSTALLATION

GUIDA ALL'INSTALLAZIONE

INSTALLATIONSANLEITUNG

INSTALLATIEHANDLEIDING

安装指南



Contents

- 2 M Series Oven
- 3 Specifications
- 7 Installation
- 7 Troubleshooting

Features and specifications are subject to change at any time without notice.

Important Note

To ensure this product is installed and operated as safely and efficiently as possible, take note of the following types of highlighted information throughout this guide:

IMPORTANT NOTE highlights information that is especially important.

CAUTION indicates a situation where minor injury or product damage may occur if instructions are not followed.

WARNING states a hazard that may cause serious injury or death if precautions are not followed.

IMPORTANT NOTE: Save these instructions for the local electrical inspector.

Product Information

Important product information including the model and serial number are listed on the product rating plate. The rating plate is located near the bottom trim on the left. The oven door must be open to view the rating plate. Refer to the illustration below.

If service is necessary, contact Wolf factory certified service with the model and serial number.

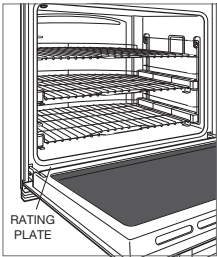

Rating plate location.

Installation Requirements

The M series oven can be installed in a standard or flush inset application. If a cooktop is being installed above an oven, a minimum of 6 mm is required between units. Location of the electrical supply within the oven opening may require additional cabinet depth.

Finish the edges of the opening. They may be visible when the door is open.

For standard installations, face trim will overlap stiles and rails. Refer to the chart below.

For flush inset installations, a minimum 3 mm reveal is required on all sides. To ensure consistent reveals, each corner of the opening must be exactly 90°.

INSTALLATION REQUIREMENTS	
BASE SUPPORT	MIN
Single Oven	115 kg
Double Oven	181 kg
TRIM OVERLAP	
Top	25 mm
Bottom	0 mm
Sides	18 mm

DUAL INSTALLATION

Two M series ovens can be installed side by side in a standard or flush inset application. A dual installation kit is required. To maintain appropriate airflow, the ovens must be installed into one opening. Any cosmetic or structural material placed between the ovens will impede airflow and is not recommended. Refer to illustrations on the following pages.

The dual installation kit is available through an authorized Wolf dealer.

Electrical

Installation must comply with all applicable electrical codes and be properly grounded (earthed).

Locate the electrical supply flush with the back wall and within the shaded area shown in the illustrations on the following pages. For ease of installation, the electrical supply for the oven can be placed in an adjacent cabinet within reach of the conduit.

Performance may be compromised if the electrical supply is less than 220 volts.

The oven is supplied with a single phase and 3-phase convertible power inlet box. The wiring diagram covering the control circuit is provided with the oven.

ELECTRICAL REQUIREMENTS		
SINGLE OVEN	SINGLE PHASE	3-PHASE
Required Power Supply	220-240 V AC	380-415 V AC
	50/60 Hz	50 Hz
Maximum Connected Load	5.4 kW	TBD
Total Amps	22	TBD
DOUBLE OVEN	SINGLE PHASE	3-PHASE
Required Power Supply	220-240 V AC	380-415 V AC
	50/60 Hz	50 Hz
Maximum Connected Load	10.8 kW	TBD
Total Amps	45	TBD

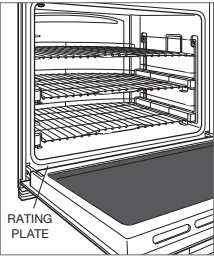

Rating plate location.

SPECIFICATIONS

M Series Single Oven

STANDARD INSTALLATION

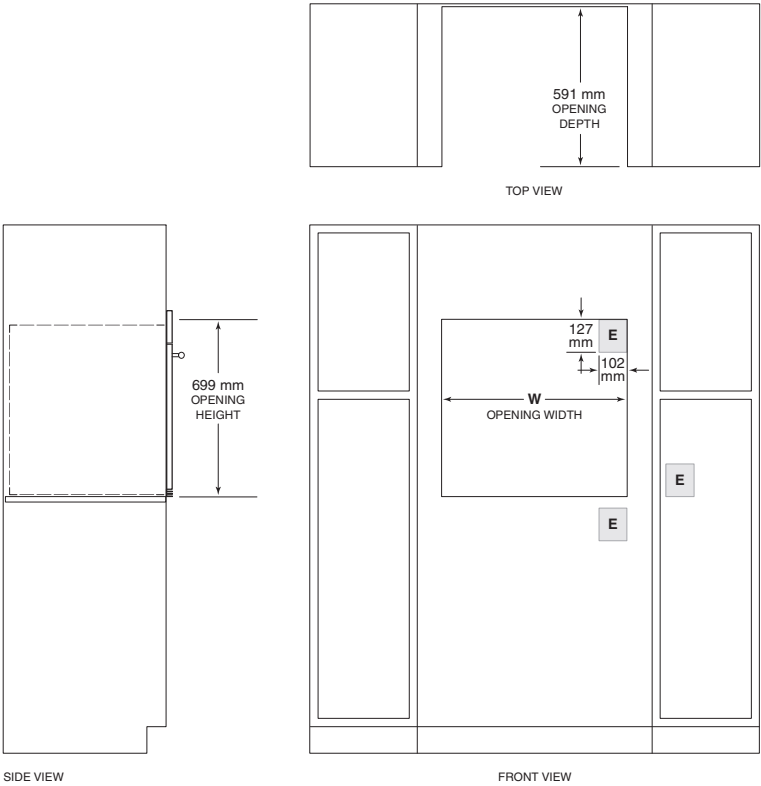

NOTE: Location of electrical supply within opening may require additional cabinet depth.
Dashed line represents profile of unit.

OPENING WIDTH		
SINGLE OVEN		W
762 mm Model		724 mm
914 mm Model		876 mm

M Series Double Oven

STANDARD INSTALLATION

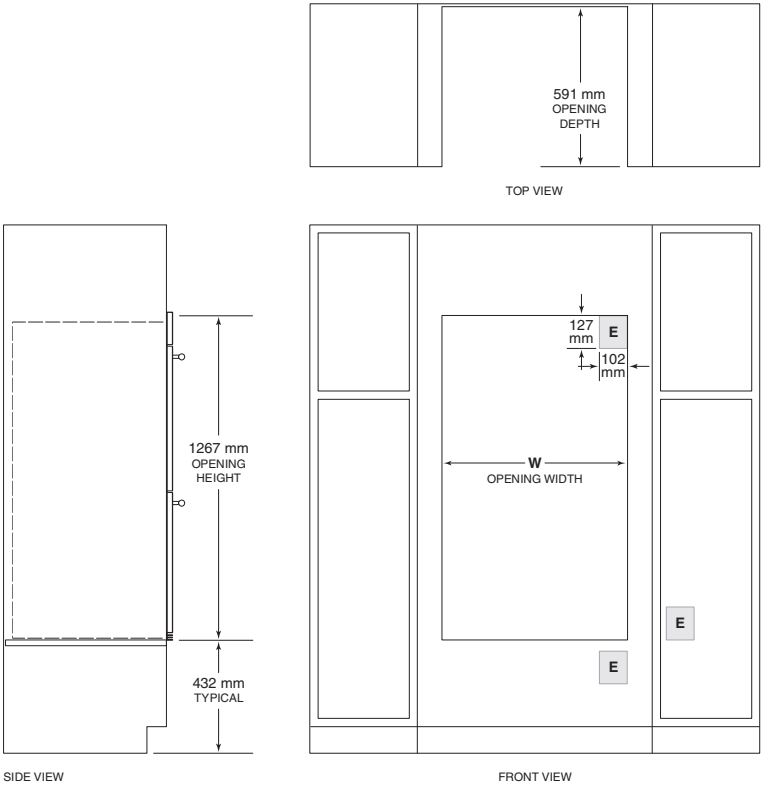

NOTE: Location of electrical supply within opening may require additional cabinet depth.
Dashed line represents profile of unit.

OPENING WIDTH		
DOUBLE OVEN		W
762 mm Model		724 mm

SPECIFICATIONS

M Series Single Oven

FLUSH INSET INSTALLATION

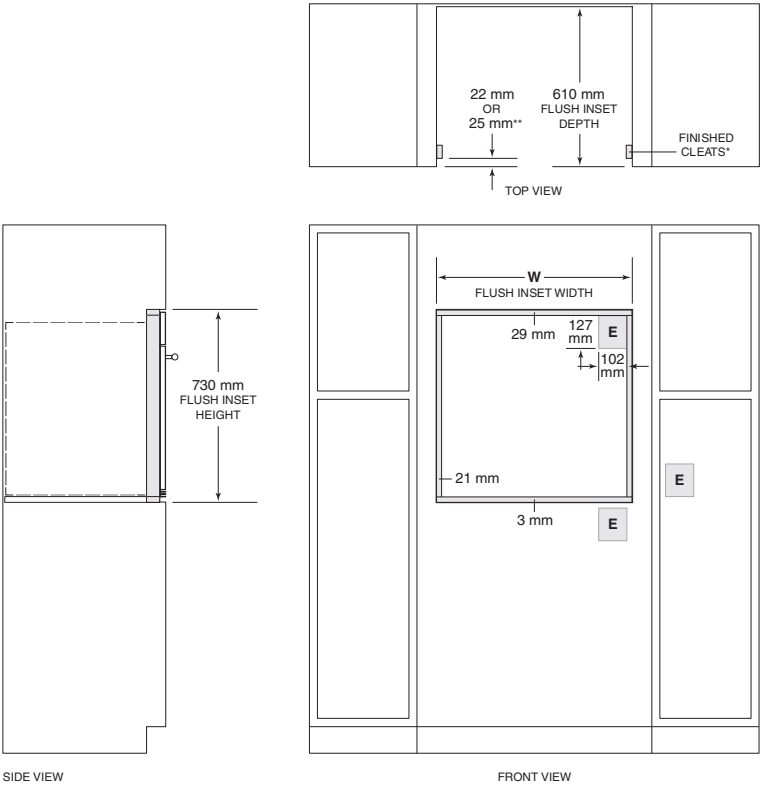

*25 mm minimum depth. Shaded areas will be visible and should be finished to match cabinetry.
**22 mm for transitional, professional and contemporary stainless steel models and 25 mm for contemporary black glass model.
NOTE: Location of electrical supply within opening may require additional cabinet depth.
Dashed line represents profile of unit.

FLUSH INSET WIDTH	
SINGLE OVEN	W
762 mm Model	765 mm
914 mm Model	918 mm

M Series Double Oven

FLUSH INSET INSTALLATION

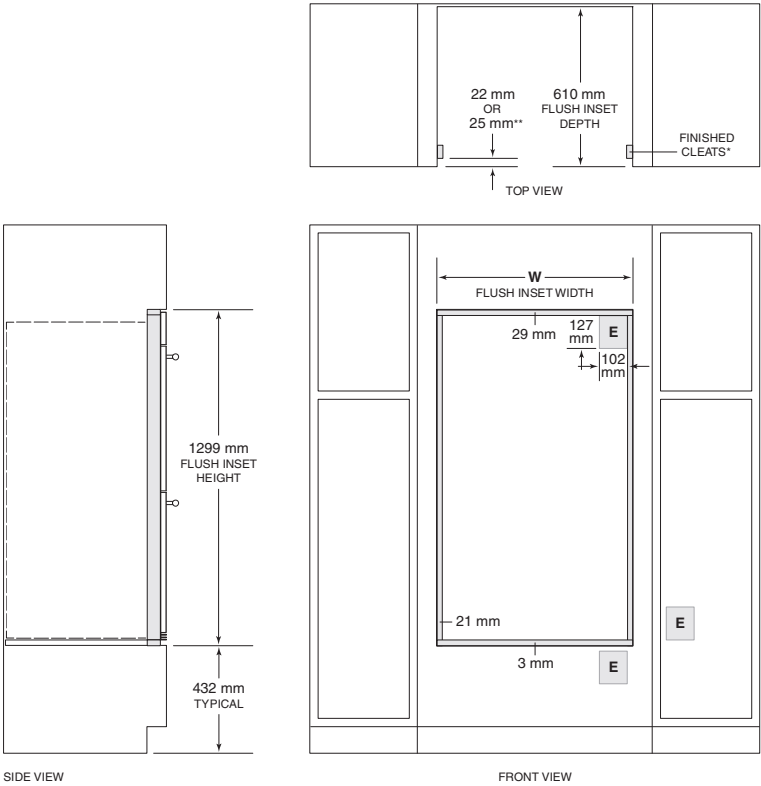

*25 mm minimum depth. Shaded areas will be visible and should be finished to match cabinetry.
**22 mm for transitional, professional and contemporary stainless steel models and 25 mm for contemporary black glass model.
NOTE: Location of electrical supply within opening may require additional cabinet depth.
Dashed line represents profile of unit.

FLUSH INSET WIDTH	
DOUBLE OVEN	W
762 mm Model	765 mm

SPECIFICATIONS

Dual M Series Ovens
STANDARD INSTALLATION

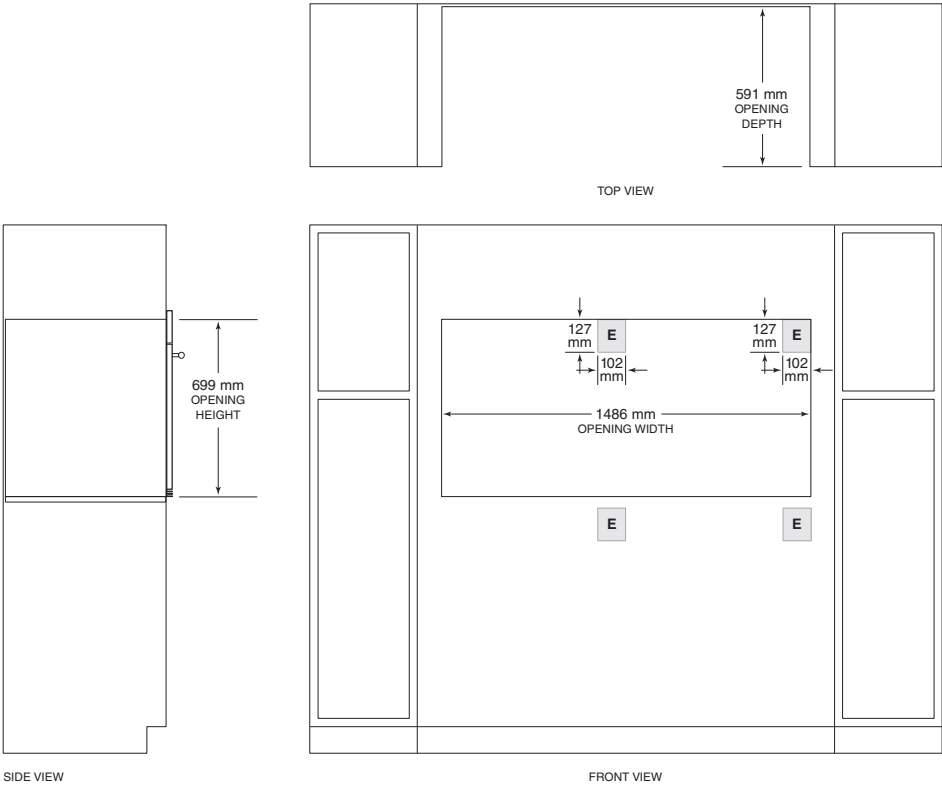

NOTE: Location of electrical supply within opening may require additional cabinet depth.

Dual M Series Ovens
FLUSH INSET INSTALLATION

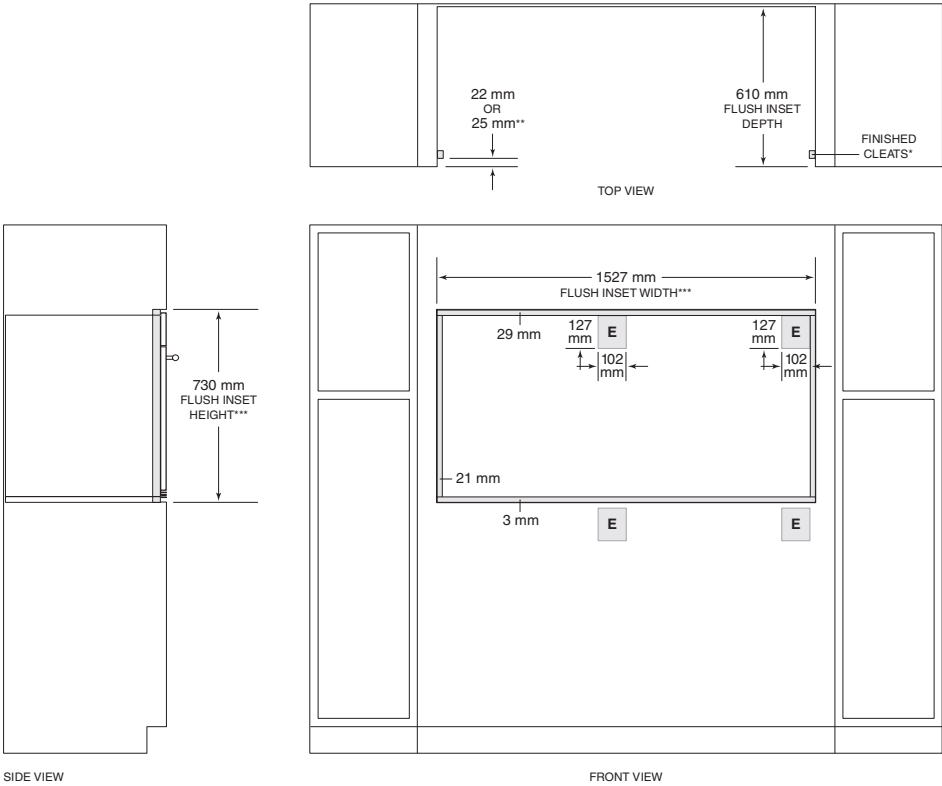

*25 mm minimum depth. Shaded areas will be visible and should be finished to match cabinetry.
**22 mm for transitional, professional and contemporary stainless steel models and 25 mm for contemporary black glass model.
***Dimension provides minimum reveals.
NOTE: Location of electrical supply within opening may require additional cabinet depth.

INSTALLATION

Preparation

Before moving the oven, protect any finished flooring and secure the oven door(s) closed to prevent damage.

Use an appliance dolly to move the unit near the opening. Place the appliance dolly on the side or back to prevent damage. Remove and recycle packing materials. Do not lift or carry the oven by the door handle.

OVEN DOOR REMOVAL

To lighten the load, the oven door(s) can be removed. Only remove if necessary. Door removal should only be done by a certified installer or service technician.

To remove, open the door completely. Rotate both hinge latches forward to the open position, remove each screw closest to the hinge, then lift the door up and out. Refer to the illustration below.

To reinstall, insert door hinges into the frame openings, then rotate hinge latches to the closed position.

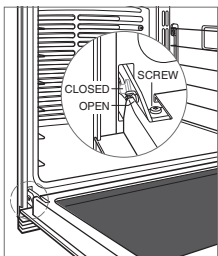

Oven door removal.

Electrical Connection

⚠ WARNING

Verify power is disconnected from the electrical box before proceeding.

Open the terminal box to expose the screws with corresponding numbers. Run the cord through the strain relief hole and into the terminal box.

For Single Phase Install (Line, Neutral, Ground): Loosen the 1, 5, and ground screws. Attach the Neutral wire to the number 5 position. Line should be attached to the 1 position and attach the ground to the corresponding ground screw.

For 3phase Install (L1, L2, L3, Neutral, Ground): Loosen the 1, 2, 3 and remove the copper bars. Loosen 5 and ground screws. Attach L1 to position 1. L2 to position 2. L3 to position 3. Neutral wire to position 5 and attach the ground to the corresponding ground screw.

After tightening the screws, tighten down the cord strain relief and close the cover to the terminal box without pinching any of the wires.

IMPORTANT NOTE: Connection of this appliance should be through a fused connection unit or a suitable isolator, which complies with national and local safety regulations. The on/off switch should be easily accessible after the appliance has been installed. If the switch is not accessible after installation (depending on country) an additional means of disconnection must be provided for all poles of the power supply. When switched off there must be an all pole contact gap of 3 mm in the isolator switch. This 3 mm contact disconnect gap must apply to any isolator switch, fuses and/or relays according to EN60335.

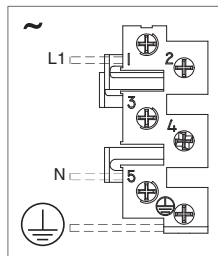

Single phase wiring diagram.

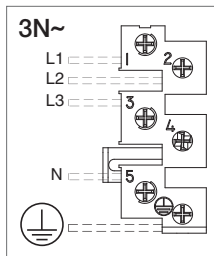

3phase wiring diagram.

Installation

Place the oven in the opening and slide into position. To ensure adequate depth for proper installation, the conduit must fit into the recessed area along the rear edge of the oven.

Locate the mounting hole in each side trim. Drill 2 mm pilot holes and install #6 x 19 mm screws. Refer to the illustration below.

Remove and recycle packing materials including the white protective material behind each rack guide mounting location.

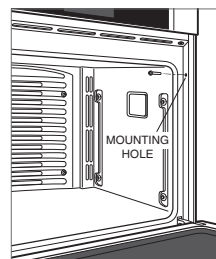

Hole location.

Troubleshooting

IMPORTANT NOTE: If the oven does not operate properly, follow these troubleshooting steps:

- Verify electrical power is supplied to the oven.
- Verify proper electrical connections.
- If the oven does not operate properly, contact Wolf factory certified service. Do not attempt to repair the oven. Wolf is not responsible for service required to correct a faulty installation.