

WARMING DRAWER INSTALLATION GUIDE

GUÍA DE INSTALACIÓN

GUIDE D'INSTALLATION

GUIDA ALL'INSTALLAZIONE

INSTALLATIONSANLEITUNG

INSTALLATIEHANDLEIDING

安装指南



Contents

- 2 Warming Drawer
- 3 Specifications
- 5 Installation
- 5 Troubleshooting

Important Note

To ensure this product is installed and operated as safely and efficiently as possible, take note of the following types of highlighted information throughout this guide:

IMPORTANT NOTE highlights information that is especially important.

CAUTION indicates a situation where minor injury or product damage may occur if instructions are not followed.

WARNING states a hazard that may cause serious injury or death if precautions are not followed.

Product Information

Important product information including the model and serial number are listed on the product rating plate. The rating plate is located on the left front floor area of the inner cabinet. The drawer must be open to view the rating plate. Refer to the illustration below.

If service is necessary, contact your authorized Wolf dealer.

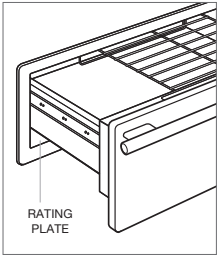

Rating plate location.

SPECIFICATIONS

Installation Requirements

The warming drawer must be installed with a Wolf drawer front, available through an authorized Wolf dealer. Specific installation instructions are included with the drawer front.

The warming drawer can be installed in a standard or flush inset application (excludes L series drawer front).

Finish the edges of the opening. They may be visible when the drawer is open.

For standard installations, face trim will overlap stiles and rails. Refer to the chart.

For flush inset installations, a minimum 3 mm reveal is required on all sides. To ensure consistent reveals, each corner of the opening must be exactly 90°.

An anti-tip block must be installed to prevent the warming drawer from tipping forward when opened.

INSTALLATION REQUIREMENTS	
BASE SUPPORT	MIN
Warming Drawer	90 kg
TRIM OVERLAP	
Top, Bottom and Sides	16 mm

Electrical

Installation must comply with all applicable electrical codes and be properly grounded (earthed).

Locate the electrical supply flush with the back wall and within the shaded area shown in the illustrations on the following page. For ease of installation, the electrical supply for the warming drawer can be placed in an adjacent cabinet within reach of the power cord.

IMPORTANT NOTE: For indoor models, a ground fault circuit interrupter (GFCI) is not recommended and may cause interruption of operation. For outdoor models, a ground fault circuit interrupter (GFCI) is required to reduce the risk of electrical shock.

ELECTRICAL REQUIREMENTS	
Electrical Supply	220-240 V AC, 50/60 Hz
Maximum Connected Load	850 W
Receptacle	grounding-type (earthed)
Power Cord	.9 m

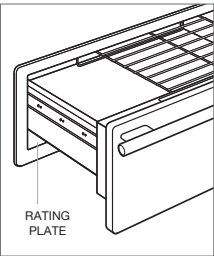

Rating plate location.

IMPORTANT NOTE: Connection of this appliance should be through a fused connection unit or a suitable isolator, which complies with national and local safety regulations. The on/off switch should be easily accessible after the appliance has been installed. If the switch is not accessible after installation (depending on country) an additional means of disconnection must be provided for all poles of the power supply. When switched off there must be an all pole contact gap of 3 mm in the isolator switch. This 3 mm contact disconnect gap must apply to any isolator switch, fuses and/or relays according to EN60335.



Electrical Shock Hazard

Plug power cord directly into a properly grounded (earthed) outlet.

Do not defeat the grounding (earthing) nature of the plug.

Do not use adapter or extension cord.

Failure to follow these instructions could cause serious injury or death.

See installation instructions

Warming Drawer

FLUSH INSET INSTALLATION

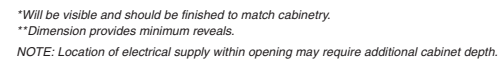
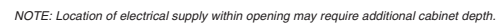

Custom front panel depth is dependent on panel thickness.

INSTALLATION

Preparation

Remove and recycle packing materials. Do not discard the package containing two screws provided for installation.

Install an anti-tip block against the rear cabinet wall. Verify screws are adequately secured and do not penetrate electrical wiring or plumbing.

Installation

- 1 Turn power off to the electrical outlet.
- 2 Slide the left corner of the warming drawer into the opening. If the electrical supply is located in the opening, plug the power cord into the receptacle. If it is located in an adjacent cabinet, guide the power cord through the hole in the cabinet wall. Coil excess power cord behind or beside the unit.
- 3 Slide the unit back into the opening until the trim meets the cabinet front. Avoid pinching the power cord between the unit and cabinet wall.
- 4 Open the warming drawer to full extension. Drill a pilot hole in each mounting hole, located at the front, on each side of the unit. Refer to the illustration below.
- 5 Mount the warming drawer using two screws provided.
- 6 Turn power back on to the electrical outlet.

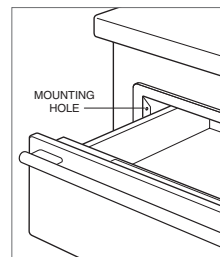

Mounting hole.

TROUBLESHOOTING

Troubleshooting

IMPORTANT NOTE: If the warming drawer does not operate properly, follow these troubleshooting steps:

- Verify electrical power is supplied to the warming drawer.
- Verify proper electrical connections.
- If the warming drawer does not operate properly, contact Wolf factory certified service. Do not attempt to repair the warming drawer. Wolf is not responsible for service required to correct a faulty installation.