

# SPEED OVEN INSTALLATION GUIDE

---

GUÍA DE INSTALACIÓN

---

GUIDE D'INSTALLATION

---

GUIDA ALL'INSTALLAZIONE

---

INSTALLATIONSANLEITUNG

---

INSTALLATIEHANDLEIDING

---

安装指南



Contents

- 2 Speed Oven
- 3 Specifications
- 5 Installation
- 5 Troubleshooting

Important Note

To ensure this product is installed and operated as safely and efficiently as possible, take note of the following types of highlighted information throughout this guide:

**IMPORTANT NOTE** highlights information that is especially important.

**CAUTION** indicates a situation where minor injury or product damage may occur if instructions are not followed.

**WARNING** states a hazard that may cause serious injury or death if precautions are not followed.

Product Information

Important product information, including the model and serial number, are listed on the product rating plate. The rating plate is located on the lower left side of the front face frame. The oven door must be open to view the rating plate. Refer to the illustration below.

If service is necessary, contact Wolf Factory Certified Service.

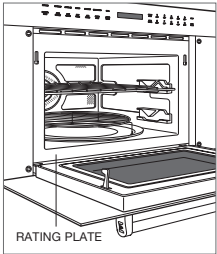

Rating plate location

SPECIFICATIONS

Installation Requirements

The speed oven can be installed in a standard or flush inset application.

Finish the edges of the opening. They may be visible when the door is open.

For standard installations, the face trim will overlap stiles and rails. Refer to the chart below.

For flush inset installations, a minimum 3 mm reveal is required on all sides. To ensure consistent reveals, each corner of the opening must be exactly 90°.

If the speed oven is installed above or below a Wolf E series oven in a flush inset application, a 6 mm reveal is required.

INSTALLATION REQUIREMENTS

BASE SUPPORT		MIN
610 mm Model		57 kg
762 mm Model		57 kg
TRIM OVERLAP		
	610 mm MODEL	762 mm MODEL
Top	5 mm	5 mm
Bottom	0 mm	0 mm
Sides	18 mm	98 mm

Electrical Requirements

Installation must comply with all applicable electrical codes and be properly grounded (earthed).

Locate the electrical supply as shown in the illustrations on the following page. The receptacle may also be located in an adjacent cabinet within reach of the power cord. A separate circuit, servicing only this appliance is required. A ground fault circuit interrupter (GFCI) is not recommended and may cause interruption of operation.

ELECTRICAL REQUIREMENTS

Electrical Supply	220-240 V AC, 50 Hz
Service	2800 W
Power Cord	1.2 m

**IMPORTANT NOTE:** Connection of this appliance should be through a fused connection unit or a suitable isolator, which complies with national and local safety regulations. The on/off switch should be easily accessible after the appliance has been installed. If the switch is not accessible after installation (depending on country) an additional means of disconnection must be provided for all poles of the power supply. When switched off there must be an all pole contact gap of 3 mm in the isolator switch. This 3 mm contact disconnect gap must apply to any isolator switch, fuses and/or relays according to EN60335.

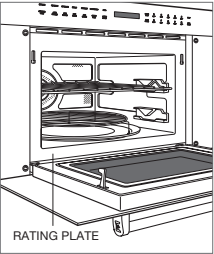

Rating plate location

SPECIFICATIONS

Speed Oven

STANDARD INSTALLATION



NOTE: 610 mm and 762 mm models require the same opening dimensions.

OPENING WIDTH	W
610 mm Model	562 mm
762 mm Model	562 mm

Speed Oven

FLUSH INSET INSTALLATION

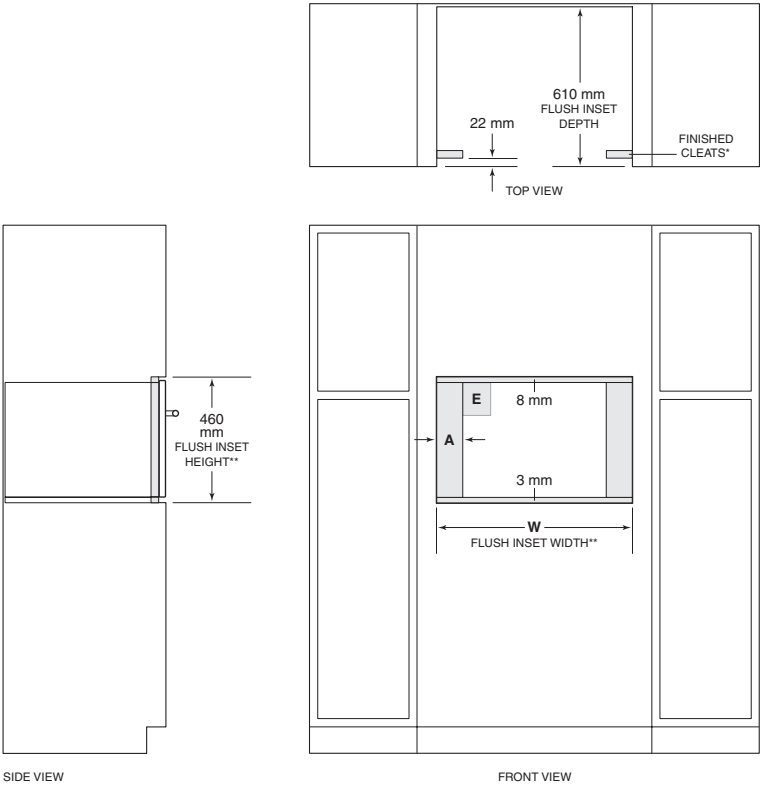

\*Will be visible and should be finished to match cabinetry.  
\*\*Dimension provides minimum reveals.

FLUSH INSET WIDTH	W	A
610 mm Model	603 mm	21 mm
762 mm Model	765 mm	102 mm

## INSTALLATION

### Installation

- 1 Turn off power to the electrical outlet.
- 2 Move the unit near the opening. Remove and recycle packing materials.
- 3 The 762 mm model is shipped with two shipping brackets located on each side, behind the front face. Remove both brackets, then reinstall the screws. Refer to the illustration below.
- 4 Plug the power cord into the grounded (earthed) outlet.
- 5 Position the oven in the opening and slide back until the mounting flange is flush with the face of the cabinet. Avoid pinching the power cord between the unit and cabinet wall.
- 6 Open the door. Using the two holes on either side of the mounting flange as a template, drill pilot holes into the cabinet.
- 7 Mount the oven using the four screws provided. Refer to the illustration below.
- 8 Turn power back on to the electrical outlet.

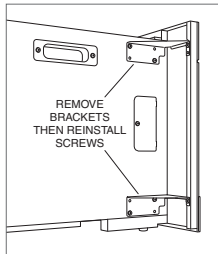

Shipping brackets

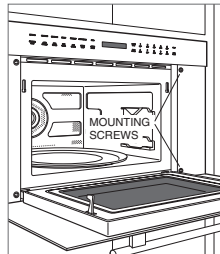

Mounting screws

## TROUBLESHOOTING

### Troubleshooting

**IMPORTANT NOTE:** If the speed oven does not operate properly, follow these troubleshooting steps:

- Verify electrical power is supplied to the oven.
- Verify proper electrical connections.
- If the oven does not operate properly, contact Wolf Factory Certified Service. Do not attempt to repair the oven. Wolf is not responsible for service required to correct a faulty installation.