

DOWNDRAFT VENTILATION

INSTALLATION GUIDE

GUÍA DE INSTALACIÓN

GUIDE D'INSTALLATION

GUIDA ALL'INSTALLAZIONE

INSTALLATIONSANLEITUNG



Contents

- 2 Downdraft Ventilation
- 3 Specifications
- 4 Installation
- 6 Troubleshooting

Features and specifications are subject to change at any time without notice. Visit wolfappliance.com/specs for the most up-to-date information.

Important Note

To ensure this product is installed and operated as safely and efficiently as possible, take note of the following types of highlighted information throughout this guide:

IMPORTANT NOTE highlights information that is especially important.

CAUTION indicates a situation where minor injury or product damage may occur if instructions are not followed.

WARNING states a hazard that may cause serious injury or death if precautions are not followed.

IMPORTANT NOTE: Save these instructions for the local electrical inspector.

Product Information

Important product information including the model and serial number are listed on the product rating plate. The rating plate is located next to the blower housing on the front side of the downdraft, below the countertop. Refer to the illustration below.

If service is necessary, contact Wolf factory certified service with the model and serial number.

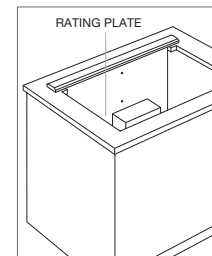

Rating plate location.

⚠ WARNING

TO REDUCE THE RISK OF FIRE, ELECTRIC SHOCK, OR INJURY TO PERSONS, OBSERVE THE FOLLOWING:

- a) Installation work and electrical wiring must be done by qualified person(s) in accordance with all applicable codes and standards, including fire-rated construction.
- b) Sufficient air is needed for proper combustion and exhausting of gases through the flue (chimney) of fuel burning equipment to prevent back drafting. Follow the heating equipment manufacturer's guideline and safety standards, and the local code authorities.
- c) When cutting or drilling into wall or ceiling, do not damage electrical wiring and other hidden utilities.
- d) Ducted fans must always be vented to the outdoors.

SPECIFICATIONS

Installation Requirements

For installation with a Wolf cooktop, a minimum 638 mm deep flat countertop is required.

For installation with a sealed burner rangetop, an accessory trim kit is required. Contact your authorized Wolf dealer for details.

The remote-mounted control module can be positioned horizontally or vertically. It must be located within 3 m of the downdraft assembly and a minimum 76 mm from the edge of the cooktop or rangetop cut-out.

BLOWERS

⚠ CAUTION

For use with Wolf 1014 m³/hr internal blower and remote blowers rated maximum 3 amps.

Internal and remote blower assemblies are available through your authorized Wolf dealer.

Internal blowers include a 152 mm round discharge, can be front or rear mounted and can be discharged in any direction by rotating the blower box. Remote blowers have a 254 mm round discharge and can be discharged from the front or rear.

DUCTWORK

Wolf downdrafts must be vented outside.

Consult a qualified HVAC professional for specific installation and ducting applications.

The downdraft will operate most efficiently with the fewest number of elbows and transitions and when ductwork does not exceed 12 m.

Electrical

Installation must comply with all applicable electrical codes and be properly grounded (earthed).

Locate the electrical supply as shown in the illustrations on pages 3–4. A separate circuit, servicing only this appliance is required. A ground fault circuit interrupter (GFCI) is not recommended and may cause interruption of operation.

Certain installations may require that the electrical supply be placed in an adjacent cabinet.

ELECTRICAL REQUIREMENTS	
DOWNDRAFTS	
Electrical Supply	220-240 V AC, 50 Hz 220 V AC, 60 Hz
Service Receptacle	10 amp dedicated circuit grounding-type (earthed)

GROUNDING INSTRUCTIONS

This appliance must be grounded. In the event of an electrical short circuit, grounding reduces the risk of electric shock by providing an escape wire for the electric current. This appliance is equipped with a cord having a grounding wire with a grounding plug. The plug must be plugged into an outlet that is properly installed and grounded.

⚠ WARNING

Improper grounding can result in a risk of electric shock. Consult a qualified electrician if the grounding instructions are not completely understood, or if doubt exists as to whether the appliance is properly grounded.

Do not use an extension cord. If the power supply cord is too short, have a qualified electrician install an outlet near the appliance.

Downdraft

INSTALLATION WITH COOKTOP

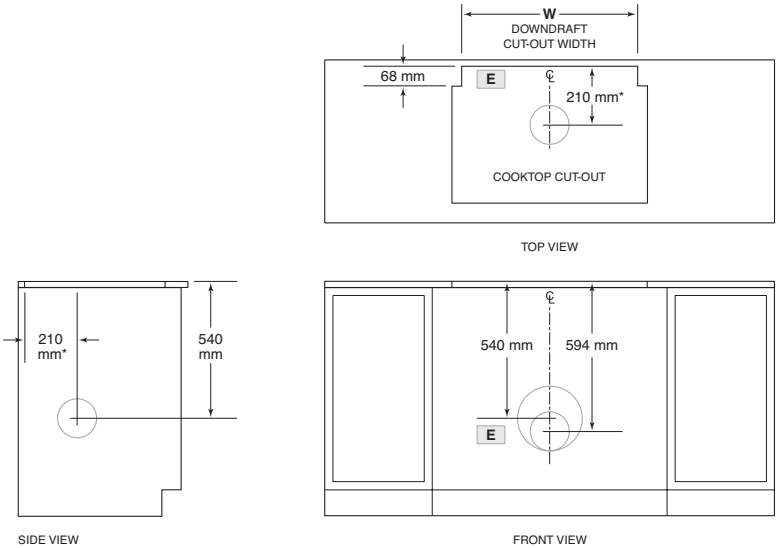

*152 mm back from countertop cut-out when internal blower is rear mounted.

NOTE: Internal blower 152 mm round, side, rear or bottom discharge. Remote blower 254 mm round, rear discharge. Centerline indicates center of downdraft cut-out.

CUT-OUT WIDTH	
MODEL	W
ICBDD30	699 mm
ICBDD36	851 mm
ICBDD45	1003 mm

SPECIFICATIONS

Downdraft

INSTALLATION WITH SEALED BURNER RANGETOP

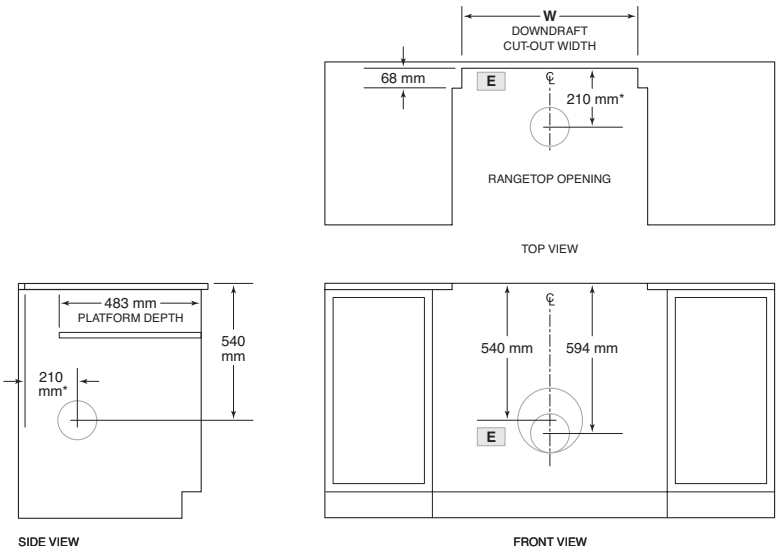

*152 mm back from countertop cut-out when internal blower is rear mounted.
NOTE: Internal blower 152 mm round, side, rear or bottom discharge. Remote blower 254 mm round, rear discharge. Centerline indicates center of downdraft cut-out.

CUT-OUT WIDTH	
MODEL	W
ICBDD30	699 mm

INSTALLATION

Installation

DOWNDRAFT

- 1 Install the top mounting brackets using the #4 sheet metal screws provided. Refer to the illustration below.
- 2 Install the lower mounting brackets using the #8 x 32 sheet metal screws provided, but do not tighten. The brackets will need to be adjusted once the downdraft is placed in the opening. Refer to the illustration below.

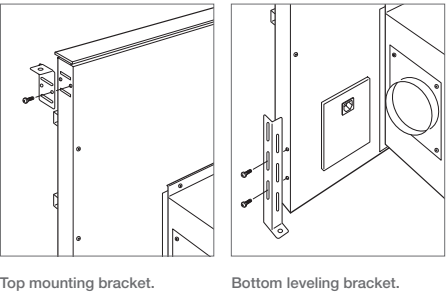

Top mounting bracket. Bottom leveling bracket.

TRANSITION

For internal blowers, remove the existing 254 mm round transition. Refer to the illustration below.

For remote blowers being discharged from the front, leave the 254 mm round transition in place.

For remote blowers being discharged from the rear, remove the 254 mm round transition from the front and solid cover from the rear of the downdraft, then reinstall the 254 mm transition on the rear and solid cover on the front.

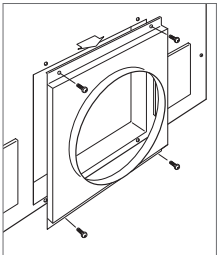

Remove transition.

Installation

INTERNAL BLOWER

To mount the internal blower on the front or rear of the downdraft:

- 1 Rotate the blower box so the 152 mm round discharge is properly located, then disconnect the cable from the downdraft receptacle and connect it to the blower receptacle. Refer to the illustrations below.
- 2 Once the blower connection is made and the discharge properly located, secure the blower to the downdraft using the four screws provided.

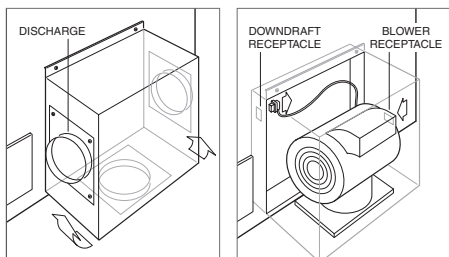

Left, right or bottom discharge. Blower connection.

To mount the internal blower on the front of the downdraft but discharge from the rear:

- 1 Remove the blower from the blower box.
- 2 Mount the blower motor to the downdraft using the two screws provided.
- 3 Remove the blower plug from the downdraft receptacle and insert it into the blower receptacle. Refer to the illustration below.
- 4 Once the plug is installed and the blower secure, install the blower box to the downdraft using the four screws provided.
- 5 Remove the 152 mm collar from the blower box and solid cover from the rear of the downdraft, then reinstall the 152 mm collar on the rear and solid cover on the blower box. Refer to the illustration below.

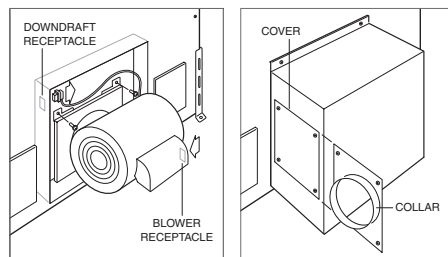

Blower mounting.

Install cover.

REMOTE BLOWER

- 1 Insert the electrical supply from the remote blower through the opening on the downdraft and secure using an approved cord strain relief.
- 2 Connect hot to brown, neutral to blue and ground to green. Refer to the illustration below.

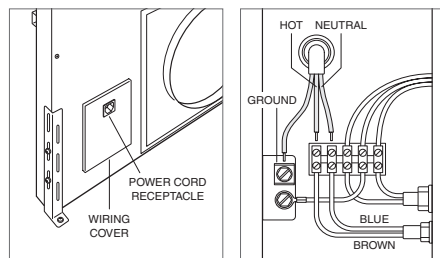

Wiring location.

Remote blower wiring.

COUNTERTOP MOUNTING

Place the downdraft in the opening, then secure the bottom brackets to the cabinet base using the wood screws provided. Once the brackets are secure, tighten the existing lower bracket screws. Refer to the illustration below.

Secure the top mounting brackets to the countertop using the wood screws provided. For solid surface countertops, silicone may be used but is not provided.

Once the top is secure, install the undercounter brackets using the screws provided then install the side covers. Refer to the illustration below.

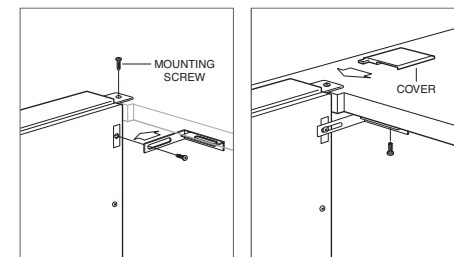

Countertop mounting.

Cover installation.

Installation

CONTROL MODULE

- 1 Use the template provided on page 7 to mark holes for mounting screws. Drill one 40 mm in the center and two 10 mm holes for the mounting screws.

⚠ CAUTION

Verify the scale of the template if not using the installation guide shipped with the downdraft.

- 2 Check countertop thickness to make sure threaded studs are long enough to allow thumbnuts to fully engage. Thicker countertops may require the countertop be countersunk from below.
- 3 Place the control module on the countertop then secure using the two nuts provided. Once secure, install the ground wire and nut.
- 4 Use provided cable or cable designated by local codes. Connect one end of the control cable to back side of control module and other to electrical connection on front of downdraft assembly. Ensure all connections are tight.

⚠ WARNING

Do not connect to telecommunication network.

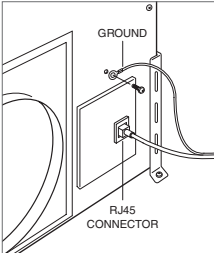

Downdraft connection.

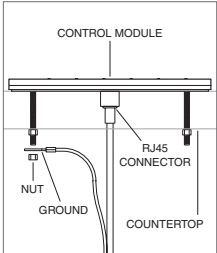

Control module connection.

TOP COVER

Insert the downdraft plug into a grounded (earthed) receptacle, then check operation. Once operation is verified, raise the chimney and install the top trim using the three nuts provided. Verify the top trim is properly aligned with the side covers. Refer to the illustration below.

FILTERS

Remove stickers and shipping brackets and install filters. Refer to the illustration below.

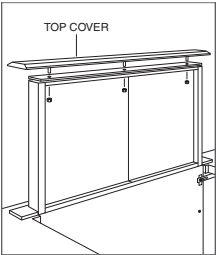

Top cover installation.

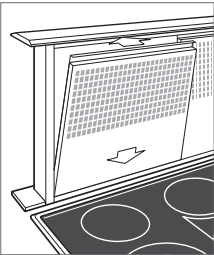

Filter installation.

Troubleshooting

IMPORTANT NOTE: If the downdraft ventilation system does not operate properly, follow these troubleshooting steps:

- Verify electrical power is supplied to the downdraft.
- Verify proper electrical connections.
- If the downdraft does not operate properly, contact Wolf factory certified service. Do not attempt to repair the downdraft. Wolf is not responsible for service required to correct a faulty installation.

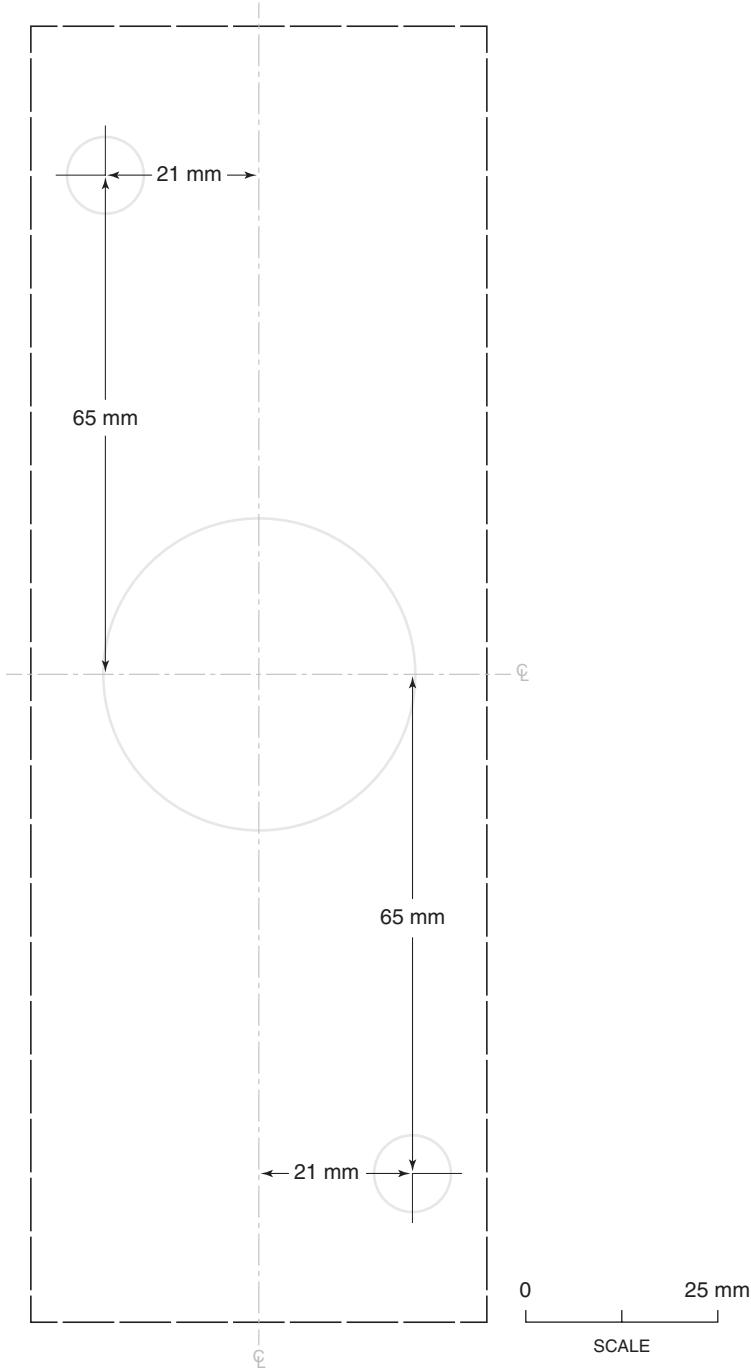

Wolf, Wolf & Design, Wolf Gourmet, W & Design and the color red as applied to knobs are registered trademarks and service marks of Wolf Appliance, Inc. Sub-Zero, Sub-Zero & Design, Dual Refrigeration, Constant Care, The Living Kitchen, Great American Kitchens The Fine Art of Kitchen Design, and Ingredients are registered trademarks and service marks of Sub-Zero, Inc. (collectively, the "Company Marks.") All other trademarks or registered trademarks are property of their respective owners in the United States and other countries.