



OUTDOOR GAS GRILL INSTALLATION GUIDE

GUÍA DE INSTALACIÓN

GUIDE D'INSTALLATION

GUIDA ALL'INSTALLAZIONE

INSTALLATIONSANLEITUNG

INSTALLATIEHANDLEIDING

安装指南



Contents

- 2 Outdoor Gas Grill
- 3 Safety Precautions
- 4 Specifications
- 7 Installation
- 10 Troubleshooting
- 11 Australia Requirements

Important Note

To ensure this product is installed and operated as safely and efficiently as possible, take note of the following types of highlighted information throughout this guide:

IMPORTANT NOTE highlights information that is especially important.

CAUTION indicates a situation where minor injury or product damage may occur if instructions are not followed.

WARNING states a hazard that may cause serious injury or death if precautions are not followed.

⚠ WARNING

FOR AUSTRALIA ONLY:

- Do not use or store flammable materials in the appliance storage drawer or near this appliance.
- Do not spray aerosols in the vicinity of this appliance while in operation.
- Do not modify this appliance.
- A ventilation unit is suggested for use with this appliance. Refer to the instructions shipped with the ventilation unit for proper clearances.
- If the information in the guide is not followed, a fire or explosion may result, causing property damage, personal injury or death.
- This appliance must be properly installed and serviced by a qualified installer, service agency or gas supplier and grounded (earthed) by a qualified technician.

Product Information

Important product information including the model and serial number are listed on the product rating plate. For outdoor grills, the rating plate is located above the drip tray, behind the logo. The drip tray must be removed to view the rating plate. For outdoor modules, the rating plate is located on the bottom of the control panel, on the right side. Refer to the illustrations below.

If service is necessary, contact your authorized Wolf dealer.

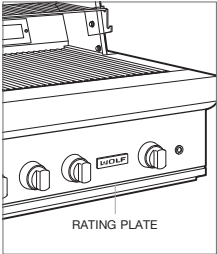

Outdoor gas grill.

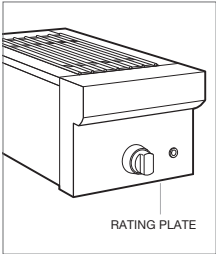

Outdoor module.

SAFETY PRECAUTIONS

IMPORTANT SAFEGUARDS

- Wolf outdoor gas grills and modules are for outdoor use only. Do not install or operate in an enclosed area.
- Installation must be performed by a qualified installer, service agency or the gas supplier.
- Warranty service must be performed by Wolf factory certified service.
- Do not store or use gasoline or other flammable liquids or vapors in the vicinity of this or any other appliance. An LP gas cylinder not connected for use shall not be stored in the vicinity of this or any other appliance.

BEFORE LIGHTING:

- Read instructions before lighting.
- Open hood or remove cover before lighting.
- If ignition does not occur in 5 seconds, turn the burner control(s) off, wait 5 minutes, and repeat the lighting procedure.

WHAT TO DO IF YOU SMELL GAS:

- Shut off gas to the appliance.
- Extinguish any open flames.
- Open hood or remove cover.
- If odor continues, keep away from the appliance and immediately call your gas supplier or fire department.

Installation Requirements

For portable applications, Wolf grill carts are designed specifically to fit grill models ICBOG30, ICBOG36 and ICBOG42 and the side burner. Model ICBOG54 is designed for built-in applications only.

For built-in applications, Wolf outdoor grills and the burner module are designed for easy placement into a built-in enclosure. For outdoor grills, installation in a combustible enclosure requires an insulating liner. For the burner module, an insulating liner is not required. The enclosure should be built according to specifications for your specific installation on page 6. If the burner module is installed next to an outdoor grill, a minimum of 305 mm is required between units. A rotisserie side conversion kit is available from an authorized Wolf dealer.

Grill carts, insulating liners and stainless steel doors and drawers are available through an authorized Wolf dealer.

Electrical

Installation must comply with all applicable electrical codes and be properly grounded (earthed).

The electrical outlet must be located within reach of the power cord. A separate circuit, servicing only this appliance is required.

IMPORTANT NOTE: A ground fault circuit interrupter (GFCI) or residual current device (RCD) is required to reduce the risk of electrical shock.

ELECTRICAL REQUIREMENTS (GRILL | MODULE)

Electrical Supply	grounded, 220-240 VAC, 50/60 Hz
Service	1 A
Receptacle	3-prong grounding-type, IEC inlet

ELECTRICAL REQUIREMENTS (ROTISSERIE)

Electrical Supply—Input	grounded, 220-240 VAC, 50/60 Hz
Electrical Supply—Output	12 VDC
Service	0.5 A (6 Watts)
Receptacle	barrel plug, 2.1 mm ID x 5.5 mm OD

⚠ WARNING

FOR AUSTRALIA ONLY:
This appliance is supplied with a cord and can be hard wired to a terminal box or plug. Do not remove the ground (earthed) plug.

N (BLUE)

P (BROWN)

E (GREEN/YELLOW)

IMPORTANT NOTE: Connection of this appliance should be through a fused connection unit or a suitable isolator, which complies with national and local safety regulations. The on/off switch should be easily accessible after the appliance has been installed. If the switch is not accessible after installation (depending on country) an additional means of disconnection must be provided for all poles of the power supply. When switched off there must be an all pole contact gap of 3 mm in the isolator switch. This 3 mm contact disconnect gap must apply to any isolator switch, fuses and/or relays according to EN60335.

Electrical Shock Hazard

Plug power cord directly into a properly grounded (earthed) outlet.
Do not defeat the grounding (earthing) nature of the plug.
Do not use adapter or extension cord.
Failure to follow these instructions could cause serious injury or death.

See installation instructions

Gas Supply

Installation must conform with local codes.

Locate the gas supply within the shaded area shown in the illustrations on page 6.

The outdoor grill is equipped for use with natural or liquid propane (LP) gas. The product rating plate has information on the type of gas that should be used. For rating plate location, refer to the illustration below. If this information does not agree with the type of gas available, check with the local gas supplier.

GAS REQUIREMENTS

NATURAL GAS	WC
Supply Pressure	12.5 mbar
Min Line Pressure	17.5 mbar
Max Regulator Pressure	100 mbar
LP GAS	WC
Supply Pressure	25 mbar
Min Line Pressure	27.4 mbar
Max Regulator Pressure	100 mbar

GAS REQUIREMENTS—FOR AUSTRALIA ONLY

NATURAL GAS	kPa
Supply Pressure	1.13
Regulator Outlet	1.00
LP GAS	kPa
Supply Pressure	2.75
Grill Regulator Outlet	2.60
Side Burner Regulator Outlet	2.70

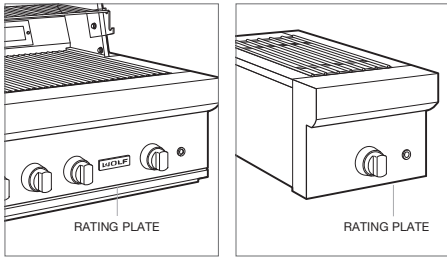

Outdoor gas grill.

Outdoor module.

SPECIFICATIONS

Gas Supply

The outdoor grill must be connected to a regulated gas supply. The supply line must be equipped with an approved external gas shut-off valve located near the grill in an accessible location. Do not block access to the shut-off valve. Refer to the illustration below.

A gas supply line of 19 mm rigid pipe must be provided to the outdoor grill or module. If local codes permit, a certified, .9 m long, 13 mm or 19 mm ID flexible metal appliance connector is recommended to connect the units 1/2" NPT (or ISO 7/1-14) female inlet to the gas supply line. Pipe joint compounds suitable for use with natural or LP gas should be used.

The appliance and its shut-off valve must be disconnected from the gas supply piping system during any pressure testing of the system at test pressures in excess of 100 mbar. The appliance must be isolated from the gas supply piping system by closing its individual manual shut-off valve during any pressure testing of the system at test pressures equal to or less than 100 mbar.

INLET THREAD CONNECTION—FOR AUSTRALIA ONLY

Burner Manifold Inlet	1/2" BSP
RV47 Regulator	1/2" BSP
RV48 Regulator	3/4" BSP (54" grill)
LP hose assembly connection to manifold	3/8" SAE flare with 5/8-18 UNF (and BSP adaptor)

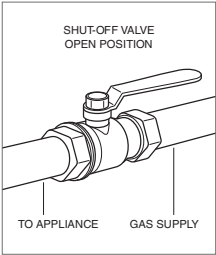

Gas shut-off valve.

GAS RATING

MODEL	TOTAL HEAT INPUT	GAS UNITS	APPLIANCE CATEGORY	TYPES/PRESSURE (mbar)	COUNTRY OF DESTINATION
ICBOG30	18.8	kW	12H	G20 at 20	AT, BG, CR, CZ, DK, EE, FI, GR, HR, HU, IS, IE, IT, LV, LT, NO, PT, RO, SK, SI, ES, SE, CH, TR, GB
				12E	DE, LU, PL
				12E+	G20 at 20/25 BE, FR
ICBOG30-LP	18.8 (1344)	kW (g/h)	13P	G31 at 37	FI, CR, GR, IE, HR, LU, NL, PL, SK, SI, ES, CH, TR, GB
ICBOG36	26.1	kW	12H	G20 at 20	AT, BG, CR, CZ, DK, EE, FI, GR, HR, HU, IS, IE, IT, LV, LT, NO, PT, RO, SK, SI, ES, SE, CH, TR, GB
				12E	DE, LU, PL
				12E+	G20 at 20/25 BE, FR
ICBOG36-LP	26.1 (1865)	kW (g/h)	13P	G31 at 37	FI, CR, GR, IE, HR, LU, NL, PL, SK, SI, ES, CH, TR, GB
ICBOG42	26.7	kW	12H	G20 at 20	AT, BG, CR, CZ, DK, EE, FI, GR, HR, HU, IS, IE, IT, LV, LT, NO, PT, RO, SK, SI, ES, SE, CH, TR, GB
				12E	DE, LU, PL
				12E+	G20 at 20/25 BE, FR
ICBOG42-LP	26.7 (1908)	kW (g/h)	13P	G31 at 37	FI, CR, GR, IE, HR, LU, NL, PL, SK, SI, ES, CH, TR, GB
ICBOG54	37.5	kW	12H	G20 at 20	AT, BG, CR, CZ, DK, EE, FI, GR, HR, HU, IS, IE, IT, LV, LT, NO, PT, RO, SK, SI, ES, SE, CH, TR, GB
				12E	DE, LU, PL
				12E+	G20 at 20/25 BE, FR
ICBOG54-LP	37.5 (2680)	kW (g/h)	13P	G31 at 37	FI, CR, GR, IE, HR, LU, NL, PL, SK, SI, ES, CH, TR, GB
ICBBM13 ICBSB13	7.3	kW	12H	G20 at 20	AT, BG, CR, CZ, DK, EE, FI, GR, HR, HU, IS, IE, IT, LV, LT, NO, PT, RO, SK, SI, ES, SE, CH, TR, GB
				12E	DE, LU, PL
				12E+	G20 at 20/25 BE, FR
ICBBM13-LP ICBSB13-LP	7.3 (518)	kW (g/h)	13P	G31 at 37	FI, CR, GR, IE, HR, LU, NL, PL, SK, SI, ES, CH, TR, GB

GAS RATING—FOR AUSTRALIA ONLY

MODEL	BURNER	GAS TYPE	INJECTOR SIZE/STAMP	GAS PRESSURE	MEGAJoule
ICBOG30/36/42	5"/6" Grill	Natural	2.50 – #41	1.0 kPa	29
ICBOG54	6" Grill	Natural	2.38 – #42	1.0 kPa	29
ICBOG30/36/42/54	5"/6" Grill	LP	1.51 – #53	2.6 kPa	30
ICBOG36/42	Sear	Natural	2.50 – #41	1.0 kPa	29
ICBOG54	Sear	Natural	2.38 – #42	1.0 kPa	29
ICBOG36/42/54	Sear	LP	1.51 – #53	2.6 kPa	30
ICBOG30/36/54	Rotisserie	Natural	1.77 – #50	1.0 kPa	15*
ICBOG42	Rotisserie	Natural	1.93 – #48	1.0 kPa	17
ICBOG30/36/54	Rotisserie	LP	1.09 – #57	2.6 kPa	15*
ICBOG42	Rotisserie	LP	1.18 – #56	2.6 kPa	17
ICBBM13	Wok	Natural	2.38 – #42	1.0 kPa	25
ICBBM13	Wok	LP	1.30	2.7 kPa	24

*Quantity 2 for ICBOG54

GAS ORIFICE SIZE

NATURAL GAS	
Main Burner (J-shaped)	#41
Small Rotisserie Burner	#50
Large Rotisserie Burner	#48
Sear Burner	#41
Burner Module/Side Burner	#238
LP GAS	
Main Burner (J-shaped)	#53
Small Rotisserie Burner	#57
Large Rotisserie Burner	#56
Sear Burner	#53
Burner Module/Side Burner	#146

SPECIFICATIONS

Outdoor Grill

NON-COMBUSTIBLE INSTALLATION

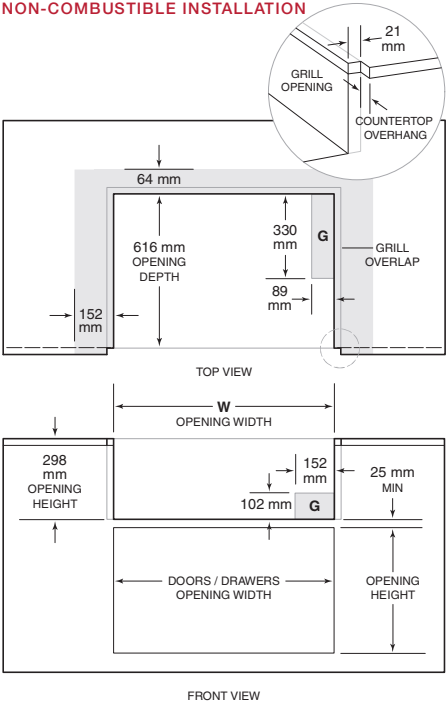

NON-COMBUSTIBLE ENCLOSURE	WIDTH (W)
ICBOG30	724 mm
ICBOG36	876 mm
ICBOG42	1029 mm
ICBOG54	1334 mm

COMBUSTIBLE INSTALLATION

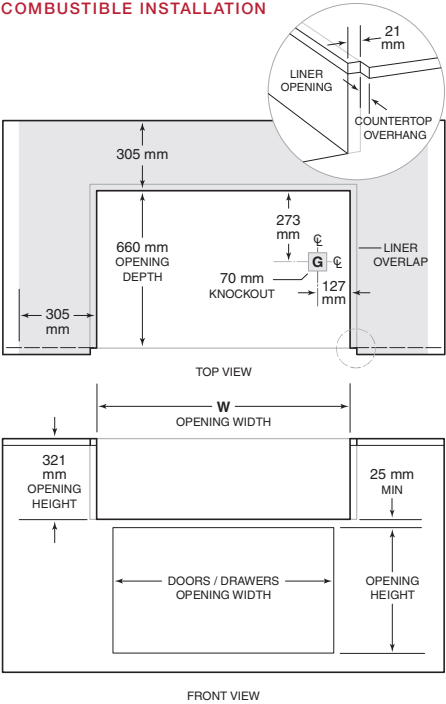

COMBUSTIBLE ENCLOSURE	WIDTH (W)
ICBOG30	851 mm
ICBOG36	1003 mm
ICBOG42	1156 mm
ICBOG54	1461 mm

ACCESSORY DOORS AND DRAWERS

OPENING	W	H
DOORS		
457 mm Single	413 mm	483 mm
762 mm Double	718 mm	483 mm
914 mm Double	870 mm	483 mm
1067 mm Double	1022 mm	483 mm
1372 mm Double	1327 mm	483 mm
DRAWERS	W	H
Single Drawer	692 mm	248 mm
2- or 3-Drawer Unit	308 mm	483 mm
Drawer/Door Unit	743 mm	483 mm

Burner Module

INSTALLATION

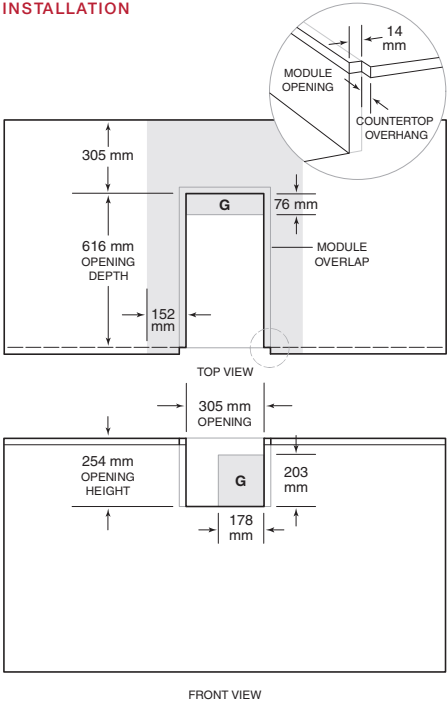

Gas Supply Line

NATURAL GAS CONNECTION

Install the natural gas pressure regulator supplied with the outdoor product with the arrow on the regulator pointing towards the unit. Refer to the illustrations below for a typical natural gas installation.

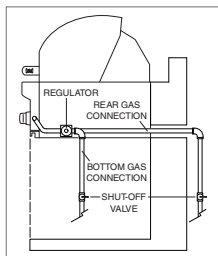

Natural gas connection.

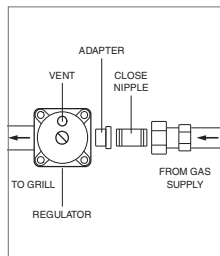

Natural gas regulator.

LP GAS CONNECTION

For whole house LP gas connection, the LP gas pressure regulator is not provided. It can be purchased from an authorized Wolf dealer.

For connection to LP gas cylinder, use only an LP pressure regulator that complies with national and local regulations (EN 16129). Flexible hose should not be more than 1.5 m, must be accessible for its entire length and should comply with national and local regulations (EN 16436-1).

- 1 Connect the $\frac{3}{8}$ " flare end of the hose to the unit coupling. Do not apply pipe sealant to the flare connection.
- 2 Install the LP gas cylinder. Pull out the shelf and place the cylinder on it. Maximum height of cylinder is 457 mm. Refer to the illustration below.
- 3 Ensure the gas valve on top of the cylinder is closed.
- 4 Connect the LP gas regulator to the cylinder and hand-tighten only. Open the cylinder valve. Check for gas leaks. Refer to the illustration below.
- 5 Tighten the LP tank retention screw to secure the cylinder to the shelf.

▲ WARNING

Perform a gas leak test each time the LP gas cylinder is changed. Do not place more than one LP gas cylinder in an enclosure at a time.

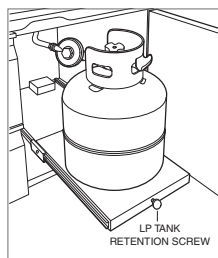

LP tank shelf.

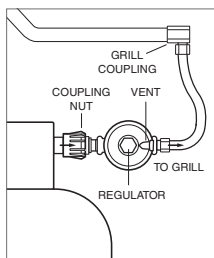

LP gas cylinder connection.

LP GAS SAFETY REQUIREMENT

This gas appliance and its individual shut-off valve must be disconnected from the gas supply piping system during any pressure testing of that system at test pressures greater than 100 mbar.

This gas appliance must be isolated from the gas supply piping system by closing its individual manual shut-off valve during pressure testing of the gas supply piping system at test pressures equal to or less than 100 mbar.

▲ WARNING

FOR AUSTRALIA ONLY:
Built-in LP cylinder enclosures refer to AS5601.1.

GAS LEAK TESTING

Perform a gas leak test at least once a year, each time the LP gas cylinder is connected to the regulator and any time part of the gas line is disconnected or replaced. This applies to natural gas as well as LP gas.

- 1 Prepare a leak testing solution of half liquid soap and half water in a spray bottle.
- 2 Verify all control knobs are in the position.
- 3 Turn the cylinder valve knob counterclockwise one turn to open.
- 4 Spray the leak testing solution on pipe joints, fittings and hose. Bubbles in the solution indicate a gas leak.
- 5 Tighten any loose joint or replace any faulty part with a Wolf replacement part to stop the leak. Do not attempt to repair the cylinder valve. If damaged, the cylinder must be replaced.
- 6 If the leak persists, shut off the gas supply at the cylinder valve and remove the LP gas cylinder. Call Wolf factory certified service. Do not use the outdoor product until the leak has been fixed.
- 7 Push in and turn any control knob to the position to release pressure, then turn the control knob back to .

▲ WARNING

To prevent fire or explosion hazard, do not smoke or permit sources of ignition in the area while performing a gas leak test. Perform the gas leak test outdoors in a well ventilated area. Never use an open flame to check for gas leaks.

INSTALLATION

Installation

PREPARATION

Remove and recycle packing materials. Remove labels and protective plastic film from the grill.

Place briquette trays in the grill above the burners with flash tubes positioned at the front. Refer to the illustration below. Place burner grates directly above the briquette trays with square openings in the grates at the front.

POWER TRANSFORMER

For built-in installation, secure the transformer box in a dry location, away from the grill firebox and excessive heat area, but within .6 m of the right rear opening. Do not install the transformer box inside the insulating liner.

For cart installation, mount the transformer box by the two screws located at the bottom right rear corner of the grill cart, behind the pull-out shelf. Utilize the same transformer for the side burner if installed.

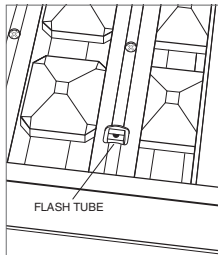

Flash tube position.

CART INSTALLATION

- 1 Two mounting screws are provided at the bottom right rear corner of the cart for the power transformer. Install the transformer box.
- 2 Remove front mounting screws from the cart. Place grill onto the cart, allowing enough space at the back to make connection to the transformer.
- 3 Make connections from the wiring harness located at the right rear of the grill to the transformer, then slide the grill back until it is fully engaged with the cart.
- 4 Secure grill to cart with four screws provided. Mounting holes in the upper back corners of the grill will align with holes in the cart. Secure with two screws. Remove the drip tray. Install two screws through side mounting holes below the grill front panel and into the cart.

Side Burner Installation

The Wolf side burner can be installed on the right side of any Wolf grill cart.

PREPARE GRILL CART

- 1 If installed, the right side shelf must be removed. To remove, lift shelf up so the lower front screw is exposed, then remove screw. Refer to the illustration below.
- 2 Fold side shelf down and remove the upper front screw, then remove the side shelf and front bracket. Refer to the illustration below.

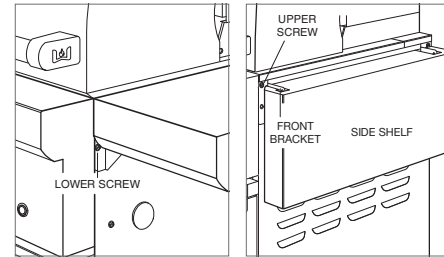

Side shelf lower screw.

Side shelf upper screw.

- 3 Remove the rear screws and bracket, then remove the cart plug from the access hole by pushing out from inside the cart. Refer to the illustration below.
- 4 For easier access, the upper rear panel and right side door of the cart can be removed. Remove the rear panel by removing four screws.
- 5 To remove the right side door, depress the rear lever on each hinge, then remove door. Refer to the illustration below.
- 6 For easier access, the drip tray of the grill can be removed. To remove, slide forward and lift out.
- 7 Insert the plastic bushing provided through access hole from inside the grill cart, where the cart plug was removed previously.

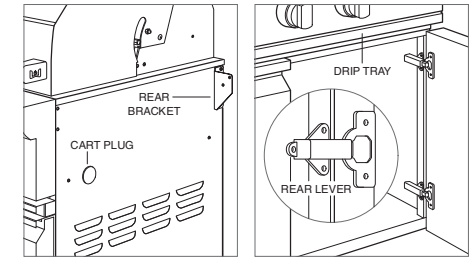

Remove rear bracket and plug. Remove cart door.

Side Burner Installation

INSTALL SIDE BURNER SHROUD

- 1 Side burner is placed inside shroud for shipping. Lift out to remove side burner from shroud.
- 2 Hang shroud by hand-starting four 10-32 machine screws provided through upper slots of shroud, into upper holes of cart. Do not fully tighten screws until shroud is properly aligned. Refer to the illustration below.
- 3 Place alignment tool provided with lip placed in the gap between the grill and shroud as shown in the illustration below.
- 4 To align front of shroud, push alignment tool back until center block of tool is flush against front vertical flange of shroud.
- 5 Align front of shroud (up and down) with alignment tool until top of tool is flush with top surface of grill bullnose. Align shroud (front to back) with tool until front of tool is flush with front of bullnose. Tighten upper screw. Refer to the illustration below.

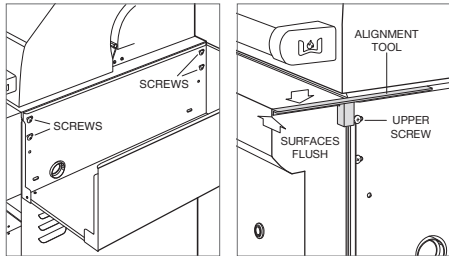

Hang shroud.

Align front of shroud.

- 6 To align back of shroud, place alignment tool at rear of shroud. Align rear of shroud (up and down) with tool until top of tool is flush with top surface of grill. Tighten upper screw. Refer to the illustration below. Verify with alignment tool that front of shroud did not move, realign if necessary.
- 7 Remove alignment tool and tighten two remaining screws to slots just below the upper screws.
- 8 Install two $\frac{5}{16} \times \frac{3}{8}$ hex drive shoulder screws provided into lower holes of shroud and through cart. Place two $\frac{1}{4}$ -20 hex nuts from inside of cart and tighten. Refer to the illustration below.

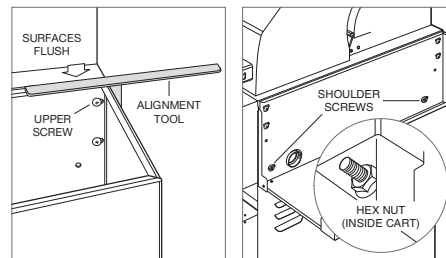

Align back of shroud.

Secure shroud.

For natural gas installations, the gas line connection must be made before installing the side burner.

INSTALL SIDE BURNER

- 1 Place side burner into shroud as shown in the illustration below. Guide flexible gas line and wire harness into cart access hole. Verify alignment of unit prior to securing side burner to shroud. If side burner does not align properly, remove, loosen screws and check shroud alignment with tool. Reposition side burner until properly aligned.
- 2 Place a bar clamp with protected ends behind bullnose on fire box and under shroud. Do not include any part of bullnose within bar clamp. Refer to the illustration below.

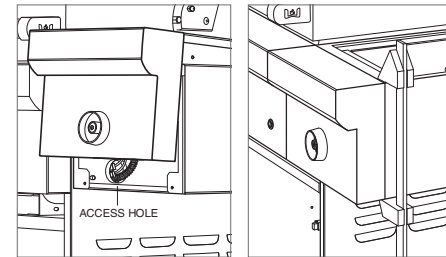

Position side burner.

Position bar clamp.

- 3 Compress bar clamp until hole in bullnose aligns with threaded hole in shroud. Alignment and placement of this screw is very important to side burner alignment. Refer to the illustration below.
- 4 Attach side burner to shroud by first placing 8-32 hex cap screw provided into right side of front underside of bullnose and into shroud. Then, place left side hex cap screw. Tighten screws and remove bar clamp.
- 5 At rear of unit, push side burner toward grill to establish proper gap at rear. Loosen rear cart screws and shift grill if necessary to achieve proper gap. Install two 8-18 pan head screws provided through shroud and into rear of side burner as shown in the illustration below. Verify proper alignment.

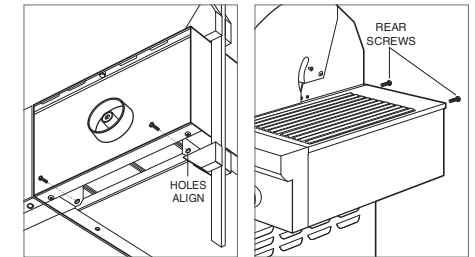

Hole alignment.

Secure side burner.

Side Burner Installation

ELECTRICAL CONNECTION

- 1 Depending on the serial number of the grill, there may be one or two connectors near the front of the grill just above the manifold. Locate the connectors by looking above the manifold near the front of the grill.
- 2 Remove the unpopulated connector housings from the wire harnesses coming from the grill as shown in the illustration below.
- 3 Attach the appropriate connector housing from the side burner to the grill. Refer to the illustration below.

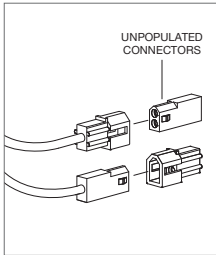

Connectors.

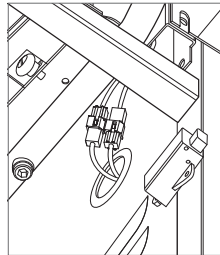

Connector housing.

LP GAS CONNECTION

- 1 Connect 2-stage LP gas regulator to flare tee at location shown. Connect flare swivel connector to one end of flare tee. Refer to the illustration below.
- 2 Connect regulator assembly to flexible gas line coming into grill cart from side burner as shown in the illustration below.
- 3 Connect regulator assembly to grill manifold at flare swivel connector as shown in the illustration below.
- 4 Reinstall rear panel and door of grill cart. Reposition grill drip tray. Place burner cap on burner head, place grate on burner pan and affix knob to bezel with bezel nylon liner.

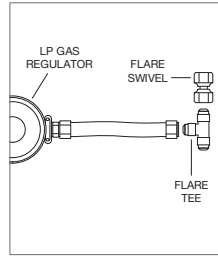

LP gas regulator assembly.

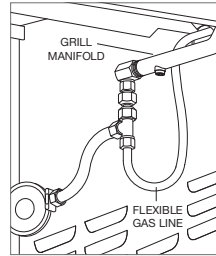

LP gas connection.

NATURAL GAS CONNECTION

- 1 Split high pressure natural gas line into two lines, one to attach to grill natural gas regulator and one to attach to side burner via flexible line and 1/2" NPT adapter. Place flexible gas line through cart access hole.
- 2 Place flexible gas line through cart access hole and attach to side burner regulator at pipe elbow. Elbow may be rotated to face downward for larger adapters. Do not rotate elbow upward. Refer to the illustration below.

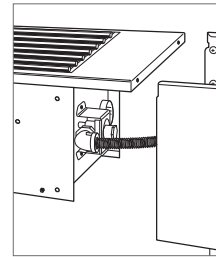

Natural gas connection.

Troubleshooting

IMPORTANT NOTE: If the outdoor gas grill does not operate properly, follow these troubleshooting steps:

- Verify electrical power is supplied to the grill.
- Verify proper gas supply.
- Verify the gas supply shut-off valve is in the open position.
- If the outdoor gas grill does not operate properly, contact Wolf factory certified service. Do not attempt to repair the grill. Wolf is not responsible for service required to correct a faulty installation.